

Plat of Survey

Barbara L. and Milton H. Luther
Reference Vol. 725 Pg. 917

Situated in the Township of Chardon, County of Geauga,
and being a part of Original Township Lot No. 147, Tract 3,
TWP. 9, Range VIII of the Connecticut Western Reserve.

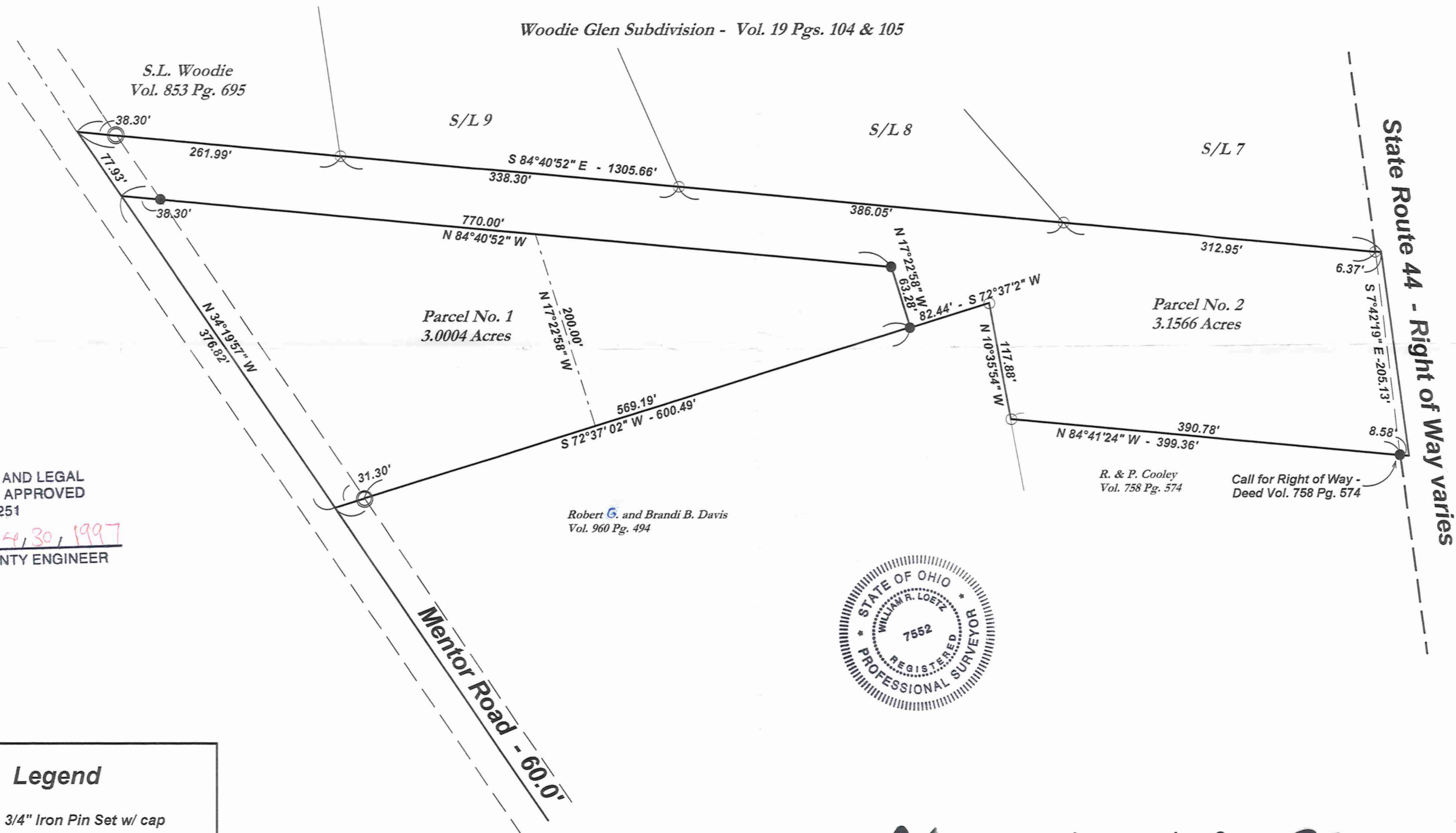
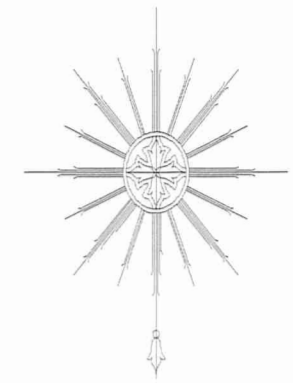

SURVEY PLAT AND LEGAL
DESCRIPTION APPROVED
PER R.C. 315.251

R.S. 4/30/1997
GEOUGA COUNTY ENGINEER



Legend

- 3/4" Iron Pin Set w/ cap
- 5/8" Iron Pin Fd.
- ⊙ 1.5" Iron Pipe Fd.

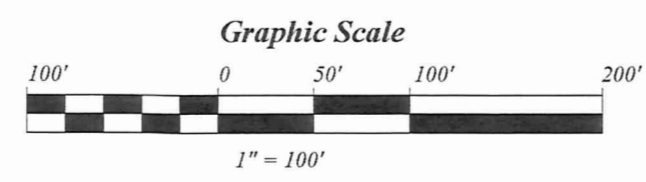

Attest: William R. Loetz Date: 4-30-97

William R. Loetz
Registered Land Surveyor No. 7552

I certify this plat represents a true and correct survey
in particulars and is based on field measurements made
under my supervision. All distances are expressed in
feet and decimal parts thereof in accordance with Ohio
Administrative Code 4733-37. Iron pin monuments were
found or set as indicated. Bearings are assumed and
are intended to denote the relationship between angles only.

MAF Surveying

PO Box 163
Madison, Ohio 44057
216-428-9563

CHA00061
CHA00061

Luther
picked up 4-30-1997
06-120485

LEGAL DESCRIPTION
3.0004 ACRES

Situated in the Township of Chardon, County of Geauga, and State of Ohio, and known as part of Original Lot 147, Tract 3 within said Township, being bounded and described as follows:

Beginning at a point in the centerline of Mentor Road, (60 feet wide), said point being the Northwesterly corner of a parcel of land deeded to Robert G. Davis and Brandi B. Davis as recorded in Vol. 960 Page 494 of Geauga County records of Deeds, and the **Principle Place of Beginning** of the parcel herein described;

Thence, North 34° 19' 57" West, along said road centerline a distance of 376.82 feet to a point;

Thence, South 84° 40' 52" East, passing through a 3/4" iron pin set at a distance of 38.30 feet, a total distance of 770.00 feet to 3/4" iron pin set;

Thence, South 17° 22' 58" East, a distance of 63.28 feet to a 3/4" iron pin set on the Northerly line of said Davis property;

Thence, South 72° 37' 02" West, along said Davis Northerly property line passing through a 1.5" iron pipe found at a distance of 569.19 feet, a total a distance of 600.49 feet to the **Principle Place of Beginning**, containing 3.0004 acres of land, more or less, subject to all legal highways as surveyed April, 1997 by William R. Loetz RLS Ohio No. S/7552. Bearings shown herein are to an assumed meridian and are used to denote angles only.

PREVIOUS RECORDING VOL. 725, PAGE 917



SURVEY PLAT AND LEGAL
DESCRIPTION APPROVED
PER R.C. 315.251

R.S. 4,30,1997
GEAUGA COUNTY ENGINEER

CHA00061

LEGAL DESCRIPTION 3.1566 ACRES

Situated in the Township of Chardon, County of Geauga, and State of Ohio, and known as part of Original Lot 147, Tract 3 within said Township, being bounded and described as follows:

Beginning at a point in the centerline of Mentor Road, (60 feet wide), said point being the Northwesterly corner of a parcel of land deeded to Robert G. Davis and Brandi B. Davis as recorded in Vol. 960 Page 494 of Geauga County records of Deeds; Thence, North 34° 19' 57" West, along said road centerline a distance of 376.82 feet to a point and the **Principle Place of Beginning** of the parcel herein described;

Thence, North 34° 19' 57" West, along said road centerline a distance of 77.93 feet to a point;

Thence, South 84° 40' 52" East, along the Southerly line of a parcel of land deed to S. L. Woodie as recorded in Vol. 853 Page 695 of Geauga County records of Deeds passing through a 1 1/2" iron pipe found at a distance of 38.30 feet, and passing through a 5/8" iron pin found at a distance of 261.99 feet to the Southwesterly corner of Woodie Glen Subdivision Vol. 19 Pages 104, 105 of the Geauga County records of Plats and continuing along said Woodie Glen Subdivision Southerly line passing through a 5/8" iron pin found at a distance of 600.29 feet, passing through a 5/8" iron pin found at a distance of 986.34 feet, passing through a 5/8" iron pin found a distance of 1299.29 feet on the Westerly right of way of SR. 44 and a total distance of 1305.66 to a point;

Thence, South 7° 42' 19" East, a distance of 205.13 feet to a point;

Thence, North 84° 41' 24" West, passing through a 3/4" iron pin set at a distance of 8.58 feet on said Westerly right of way of said SR 44, also being the Northeasterly corner of R. & P. Cooley Vol. 758 Page 574 of the Geauga County records of Deeds and continuing along said Cooley Northerly line a total distance of 399.36 to a 5/8 iron pin found on the Easterly line of said Davis property;

Thence, North 10° 35' 54" West, along said Davis Easterly line a distance of 117.88 feet to a 5/8 iron pin found at the Northeasterly corner thereof;

Thence, South 72° 37' 02" West, along said Davis Northerly line a distance of 82.44 feet to a 3/4 iron pin set;

Thence, North 17° 22' 58" West, a distance of 63.28 feet to a 3/4 iron pin set;

Thence, North 84° 40' 52" West, passing through a 3/4" iron pin set at a distance 731.70 feet, a total distance of 770.00 feet to the **Principle Place of Beginning**, containing 3.1566 acres of land, more or less, subject to all legal highways as surveyed April, 1997 by William R. Loetz RLS Ohio No. S/7552. Bearings shown herein are to an assumed meridian and are used to denote angles only.

PREVIOUS RECORDING VOL. 725, PAGE 917

SURVEY PLAT AND LEGAL DESCRIPTION APPROVED PER R.C. 315.251

R.S. 4/30/1997
GEAUGA COUNTY ENGINEER

